

## FYI

- Landfill fees are doubled if the load is uncovered or unsecured.
- Loads with 25% or more of Rock, Concrete, or Masonry are charged at the \$100.00 per ton rate for secured loads, and at the \$200.00 per ton rate for unsecured loads.
- Fees are subject to change per City Commission action.
- Please call for any questions about tipping fees or landfill policies at (785) 826-7395.

## Scrap Metal

The landfill collects scrap metal items (e.g., washers, dryers, water heaters, etc.) for recycling. Separate scrap metal items from other waste. A Freon removal certificate is needed for items like refrigerators, freezers, A/C units, and dehumidifiers. Freon removal services are available at local businesses.

## Contact Information

4292 S Burma Rd, Salina, KS 67401  
(785) 826-7395  
[salina-ks.gov/landfill](http://salina-ks.gov/landfill)



## Landfill Hours:

### Monday - Friday

7:00 a.m. - 4:30 p.m.

### Saturday

8:00 a.m. - 2:00 p.m.

### Closed Early

Memorial Day, Independence Day,  
and Labor day - 2:00 p.m.

### Closed

New Year's Day, Thanksgiving Day,  
and Christmas Day



A **Secured Load** means the items are fastened to the vehicle or trailer in such a way so that they will not fall off or blow out of the vehicle during transport.

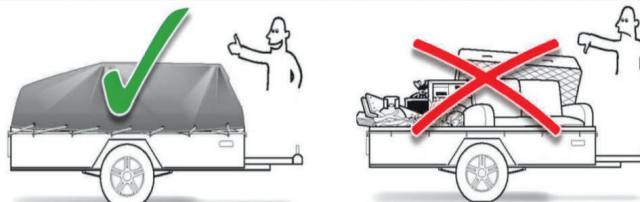

## Municipal Solid Waste Landfill

4292 S Burma Rd  
(785) 826-7395  
[salina-ks.gov/landfill](http://salina-ks.gov/landfill)

## Landfill Fees

### Secured

- Up to 500 lb. (minimum fee) \$12.50
- Over 500 lb. \$50.00/ton
- Residential Yard Waste Free
- Commercial Yard Waste \$25.00/ton

### Unsecured

- Up to 500 lb. (minimum fee) \$25.00
- Over 500 lb. \$100.00/ton
- Residential Yard Waste \$12.50
- Commercial Yard Waste \$50.00/ton

## Tires

Auto - No rim	\$4.50
Auto - w/rim	\$11.00
Truck - No rim	\$11.50
Truck - w/rim	\$18.00
Equipment/Truck - No rim	\$50.75
Equipment/Truck - w/rim	\$57.25
18.4" - 23.4" No rim	\$98.00
18.4" - 23.4" w/rim	\$104.50
23.5" - 30.5"	\$221.00

## Special Items

### Secured

- Asbestos Friable \$100.00/ton
- Asbestos Non-Friable \$50.00/ton
- Contaminated Soil \$100.00/ton
- Rock, Concrete, Masonry \$100.00/ton

### Unsecured

- Asbestos Friable \$200.00/ton
- Asbestos Non-Friable \$100.00/ton
- Contaminated Soil \$200.00/ton
- Rock, Concrete, Masonry \$200.00/ton

## Construction & Demolition

Large metal items (I-beam, large pipe, large square or rectangular tubing, etc.) and large exchange units will need to be separated from other waste.

Large wooden structures (beams, posts) can be no longer than 12 ft. in length.

Railroad ties, bridging, crossovers, bridge timbers, and electric line poles require a telephone call to the landfill prior to disposal. The acceptance of these items are subject to daily landfill operations.

Large slab sections, panels, stem walls, reinforced concrete pipe not broken into a manageable size (no larger than 1' x 4' x 4') will not be accepted.

*Aggregate items that are under 12" in diameter, clean of all trash, soils, wire, rebar, and other metal binding components can be exempt from disposal fees upon the approval of the Landfill Superintendent.*

Asbestos, contaminated soils, or contaminated items require a **Special Waste Authorization** document from the **KDHE**. *If the soil is uncontaminated, the landfill may take it for free with the approval of the Landfill Superintendent.*

## Items Not Accepted

- Ammunition
- Any items containing Freon (unless certified that the Freon has been removed).
- Batteries
  - Button cell
  - Lithium-ion
  - Rechargeable
- Corrosive wastes
- Explosives
- Firearms
- Flammable liquids or solids
- Hazardous wastes
- Propane tanks
- Reactive wastes
- Toxic wastes

Contact the Saline County Sheriff's Office for disposal instructions on Ammunition, Firearms, and Explosives.

- 800 E Pacific Ave, Salina, KS 67401  
(785) 826-5000

Contact the Household Hazardous Waste Facility for disposal instructions of other wastes listed above.

- 315 E Elm St, Salina, KS 67401  
(785) 826-6638
- Hours:
  - Thursday 7:30 a.m. - 7:00 p.m.
  - First Saturday of each month 8:00 a.m. - 12:00 p.m.
  - or call for an appointment
  - [salina-ks.gov/hhw](http://salina-ks.gov/hhw)